

CHANGING BLADE INSTRUCTIONS

For all auto-lock style knives.

Models: BN-AL, LA-X, MXP-AL, NA-1, NL-AL, SL

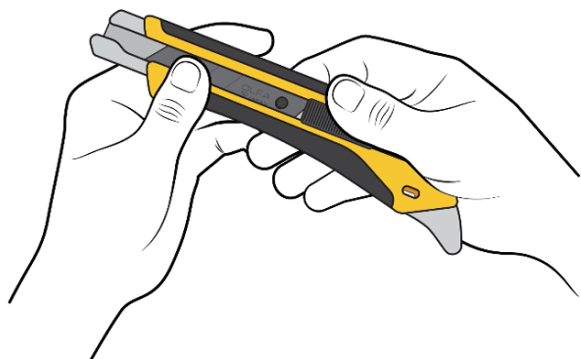

1 Push down on slider assembly and slide towards back end.

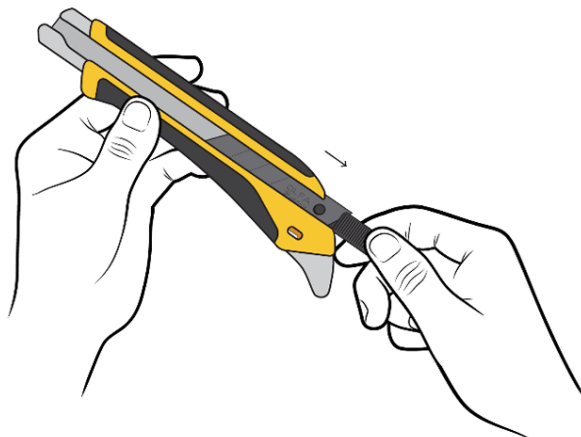

2 Push slider assembly past the base of handle to remove.

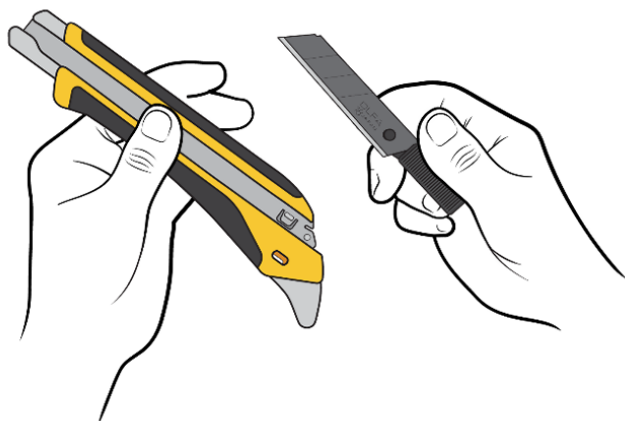

3 Remove slider assembly from blade. Carefully slide used blade section out of handle and dispose of properly in sharps container.

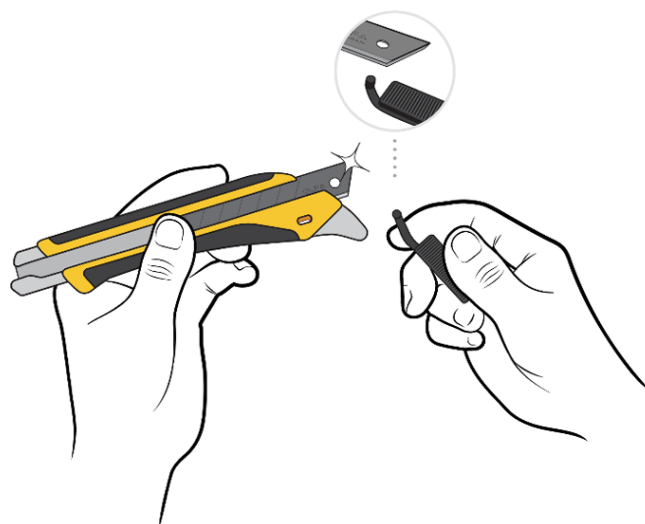

4 Slide new blade into channel. Align blade by placing the hole in the blade over the raised mounting point on slider assembly.

CHANGING BLADE INSTRUCTIONS

For all auto-lock style knives.

Models: BN-AL, LA-X, MXP-AL, NA-1, NL-AL, SL

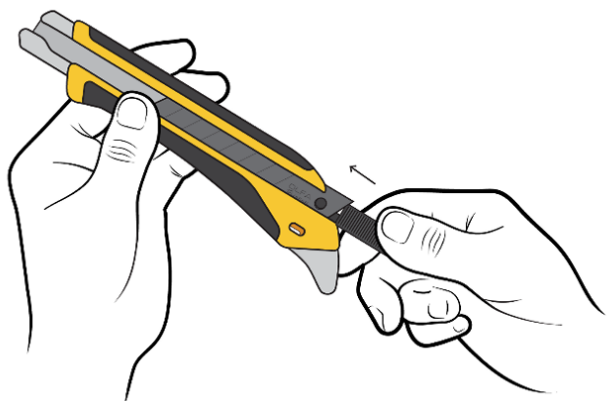

5 Push slider assembly and blade forward in handle to lock into place.

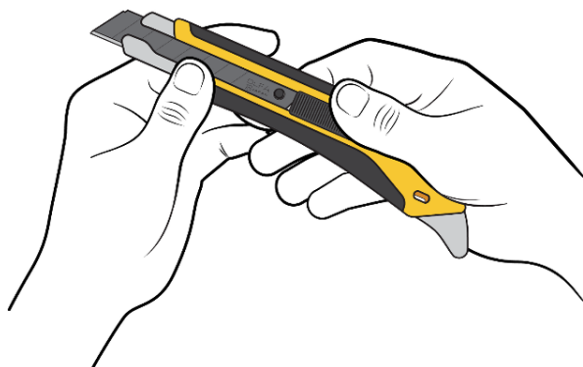

6 New blade is now ready for use.