

CHANGING BLADE INSTRUCTIONS

For all ratchet-wheel style knives.

Models: CL-1, H-1, L-1, L-2, L-5, MXP-L, NH-1, NOL-1, OL, XH-1, XL-2, 300

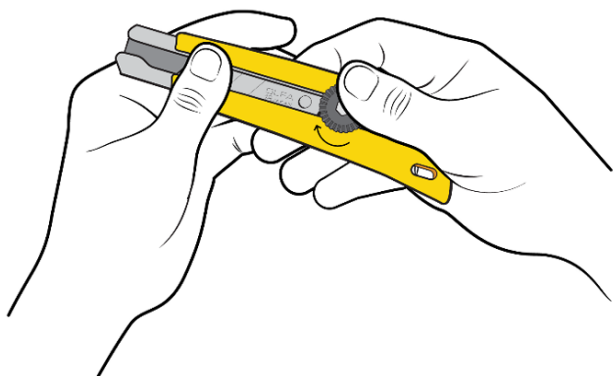

1 Turn ratchet-wheel dial counter-clockwise to loosen locking mechanism.

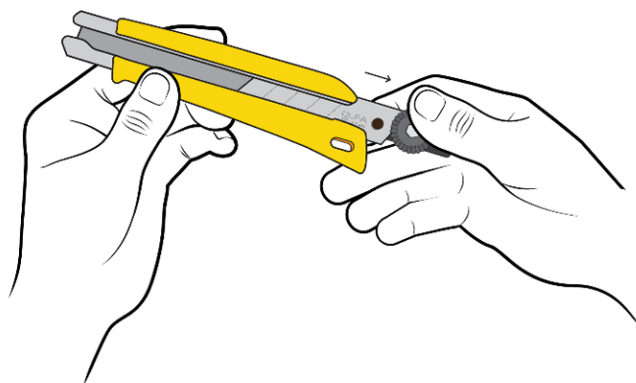

2 Slide ratchet-wheel assembly past base of handle to remove.

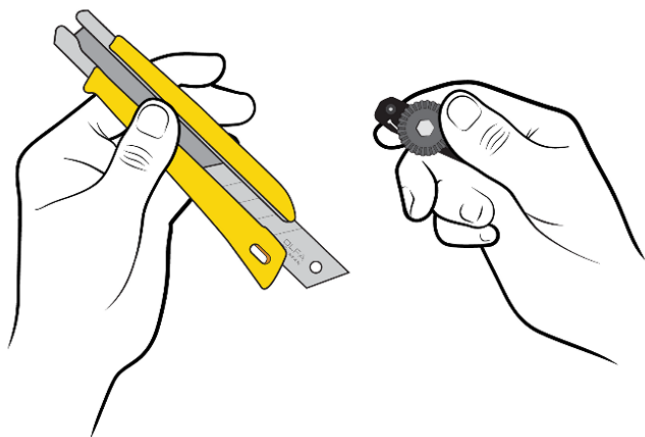

3 Remove ratchet-wheel dial from blade. Carefully slide used blade section out of handle and dispose of properly in sharps container.

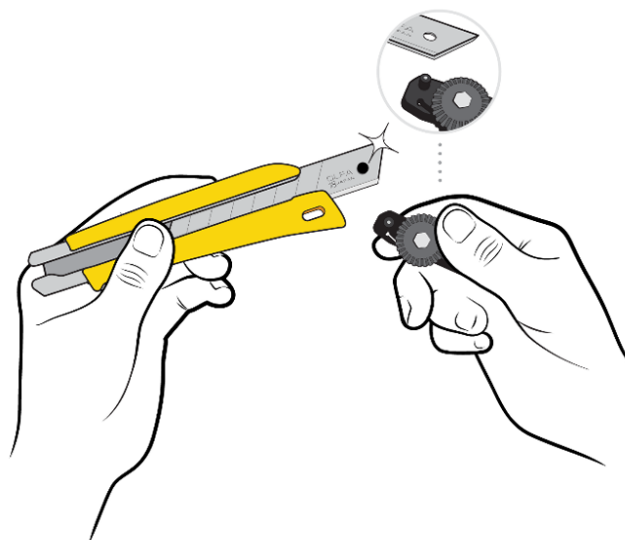

4 Insert new blade into channel. Align with assembly by placing the hole in the blade over the raised mounting point.

CHANGING BLADE INSTRUCTIONS

For all ratchet-wheel style knives.

Models: CL-1, H-1, L-1, L-2, L-5, MXP-L, NH-1, NOL-1, OL, XH-1, XL-2, 300

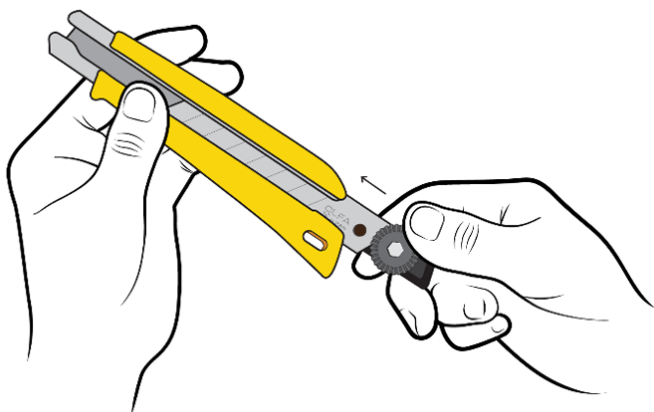

5 Slide ratchet-wheel assembly and blade forward.

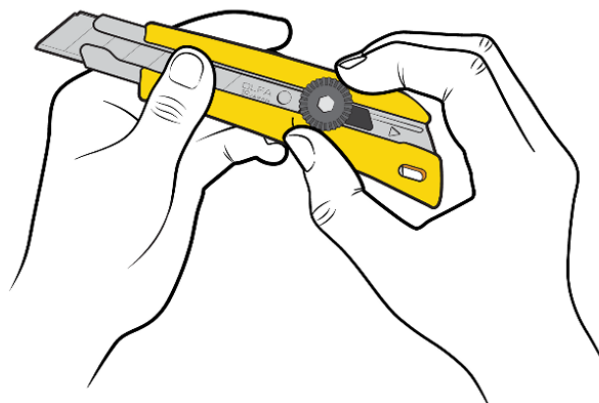

6 Turn ratchet-wheel dial clockwise to tighten the locking mechanism and return to work.